

GM 5-9

Coverage chart  $n \approx 2800$  rpm

Submersible drainage pump

# GM 5-9

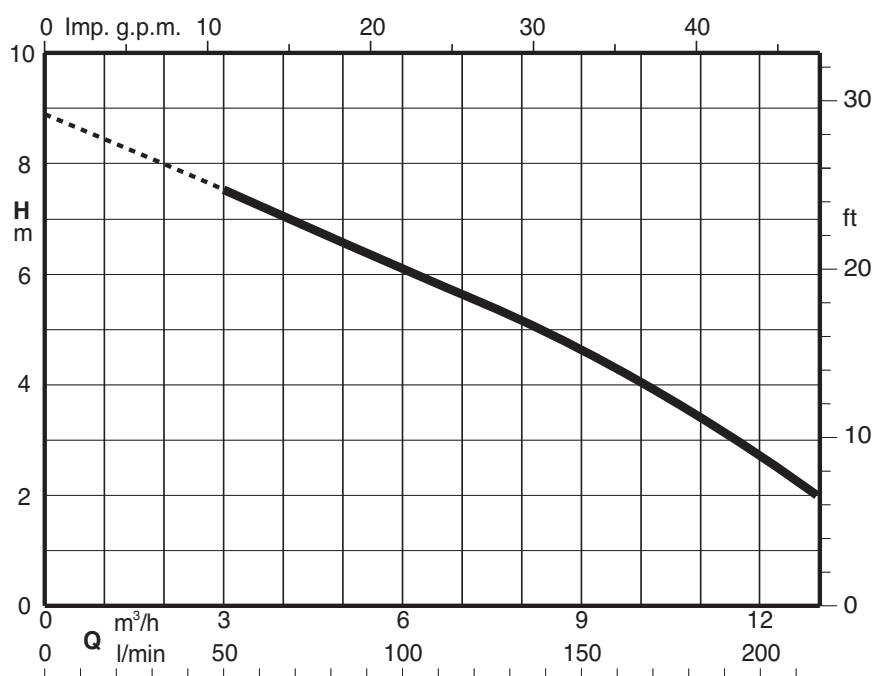

Construction

Submersible drainage pump constructed with composite polymers developed especially for this product.  
Double shaft seal with oil chamber.  
Compact in size yet delivering excellent performance, this pump is suitable for a wide range of applications, with flow rates of up to 217 liters per minute. It is equipped with a float switch for automatic start and stop.  
With float switch for automatic start and stop.

Applications

For clean water with suspended solids up to a diameter of 5 mm.  
For draining flooded rooms or tanks.  
Water extraction from ponds, flowing streams, or pits for rainwater collection.  
For irrigation.

Operating conditions

Maximum liquid temperature for prolonged use: 35 °C (with immersed motor).  
Immersion depth: 5 m max.

Motor

2-pole induction motor, 50 Hz ( $n \approx 2800$  1/min).  
Single-phase 230 V  $\pm$  10%, with thermal protector.  
Incorporated capacitor  
Cable H05RN-F, 3G0,75 mm2: with plug, length 10 m, 245IEC57, according to EN 60335-2-41 for pumps up to 10 kg.  
Insulation class F.  
Protection IP 68.

Materials

Components	Materials
Pump casing	PP+GF30
Impeller	PA66+GF30
motor jacket	Chrome-nickel steel 1.4301 EN 10088 (AISI 304)
Pump jacket	PP+GF30
Filter	PP+GF30
Handle	PP+GF30
Shaft	Steel C45E EN 10083-2
Mechanical seal	Graphite/Ceramic/NBR

Performance  $n \approx 2800$  rpm

Single-phase

					Q = Flow							
					m³/h	0	1,2	3	6	9	12	13
Model	230V	P2		P1	l/min		20	50	100	150	200	217
	A	kW	HP	kW	H (m) = Total head							
GM 5-9	2,4	0,33	0,45	0,55		8,9	8,2	7,6	6,1	4,7	2,8	2

P1: Maximum power input.  
P2: Rated motor power output.  
H: Total head in m

Dimensions and weights

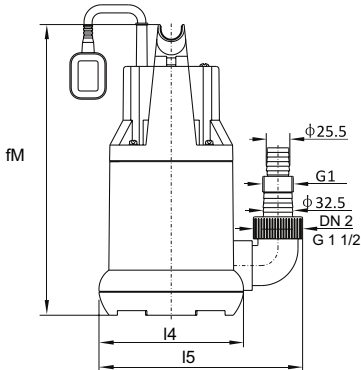

TYPE	DN2	mm					kg
		fM	I4	I5	Lmax	Lmin	Weight
GM 5-9	G 1 1/2	316	157	222	340	120	4.7

Examples of installations

